

PACKAGE INCLUDES

- 1 x 16.4 feet COB LED strip (A), 2 x female socket (B)
- 1 x power supply 24V/2.5A (C), 1 x DC Y splitter connector (D)
- 1 x single color LED controller (E)
- 1 x rotating wheel remote (F)

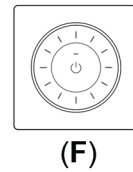
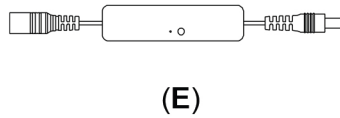
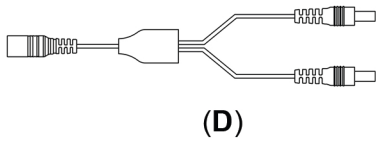
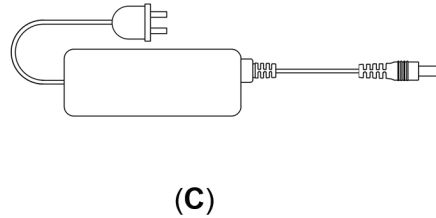
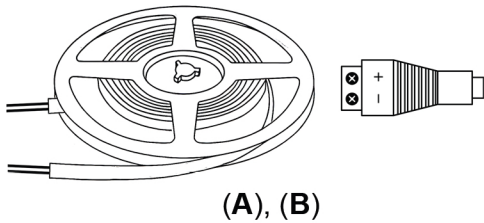

INSTALLATION

1 WIRING DIAGRAM:

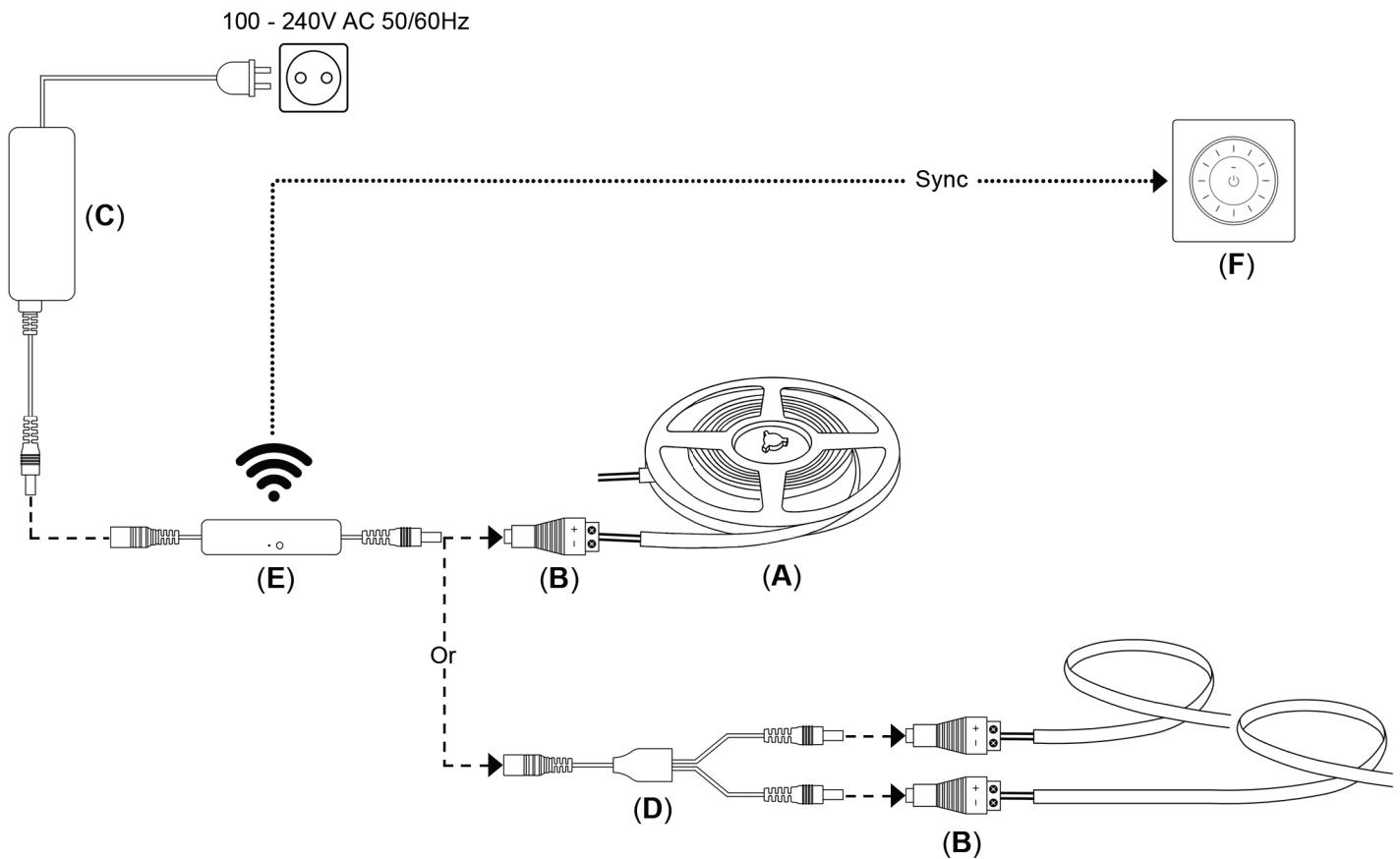

2 HOW TO INSTALL:

■ INSTALL TAPE LIGHT:

- Calculate the needed length and cut off the extra length along the cutting mark if necessary.

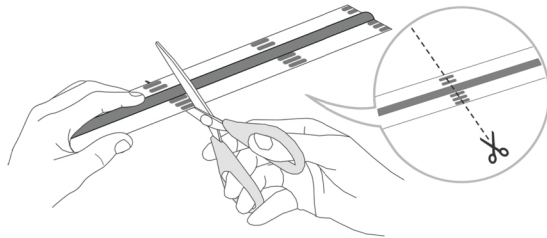

- Peel off the release paper of the tape step by step. Don't peel off all release paper at one time to avoid tangling the strip.

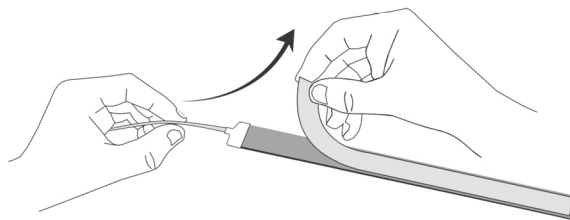

- Apply tape to isolate the cutting position from the surface, then press the strip which sticking on the surface.

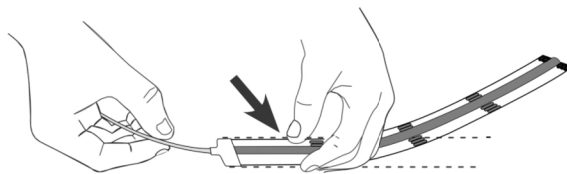

■ CONNECT THE TAPE LIGHT WITH SOCKET:

- Loosen the screw.
- Put the wire end of the LED strip into the DC connector connection hole.
- Tighten the screw.

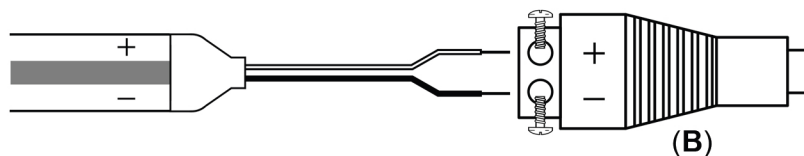

■ CONNECT CONTROLLER WITH SOCKET AND POWER SUPPLY:

On the controller (E):

- Connect the male end of the controller cable to the female socket (C).
- Connect the female end of the controller cable to the male end of the power supply (B) cable

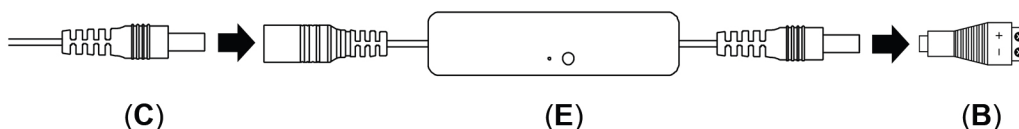

■ SETTING ROTATING REMOTE WHEEL:

Button description:

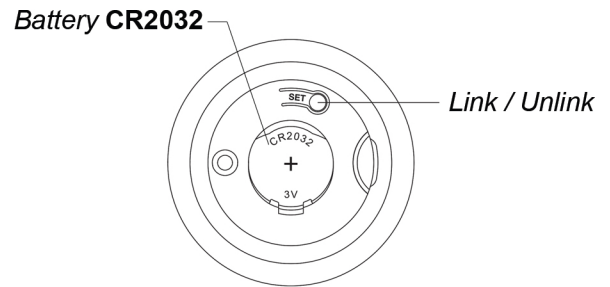
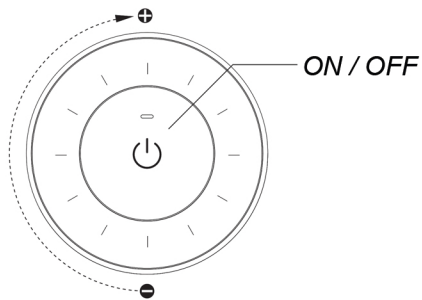

Install battery:

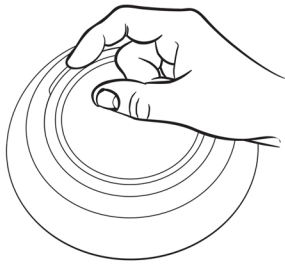

Open battery cover

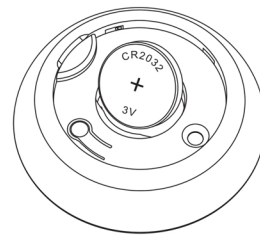

Install the battery as shown in the photo

■ CONNECT CONTROLLER WITH ROTATING REMOTE WHEEL:

Linking:

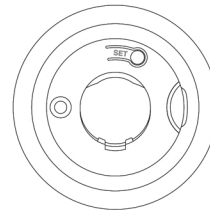
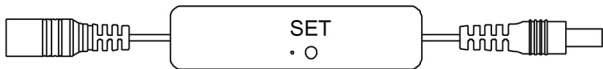

1 Press the "SET" button on the LED controller once.

2 Then, press the "SET" button on the back of the remote control three times, the LED strip starts blinking.
Wait for the LED strip to stop blinking, the connection process is now complete.

Unlinking:

To disconnect the remote controller from the LED controller, press and hold the "SET" button on the LED controller until the LED strip starts blinking. Once the blinking stops, the remote controller has been disconnected.

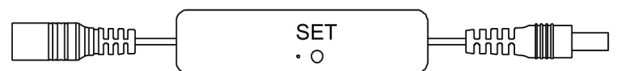

Installation remote

Method 1:

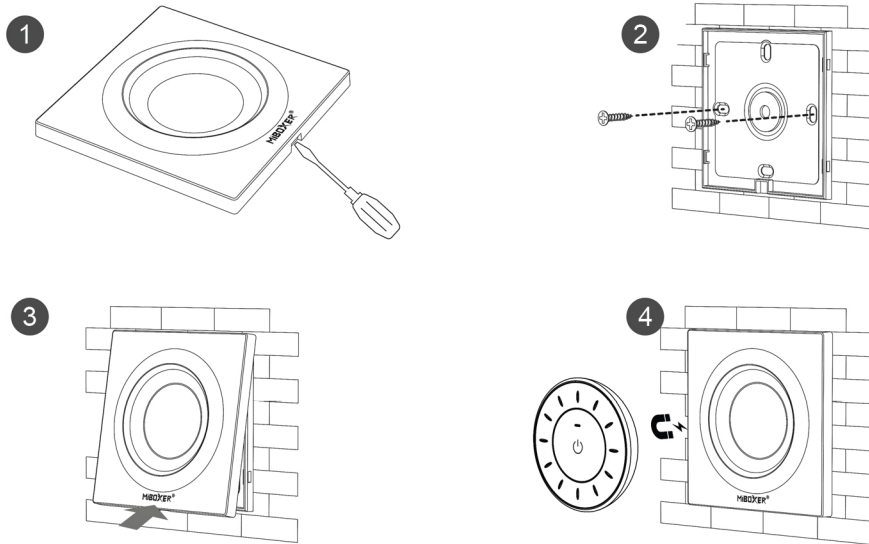

Method 2:

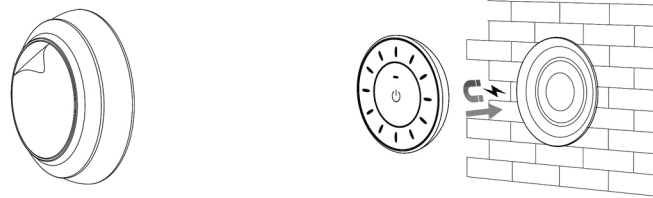

Take off the double - sided tape on the back of the base

Stick the base well, and the remote control is magnetically attracted to the base

SPECIFICATION

COB LED STRIP (A)

- Input Voltage: 24V DC 3.2W/Ft
- LED type: 480PCS/M COB
- Length: 16.4Ft
- Width: 0.31"
- IP rating: IP20
- Cut points: 50mm
- Color rendering index: Ra > 90

POWER SUPPLY (C)

- Input Voltage: 100-240V AC 50/60Hz
- Output Voltage: 24V DC 2.5A
- Power factor: >0.85

CONTROLLER (E)

- Input Voltage: DC 12-24V
- Output current: max 6A
- Output power: 72-144W
- Output type: constant voltage
- Control signal: 2.4Ghz RF
- Control distance: 30m
- IP rate: IP20
- Working temp: -10 - 40°C
- Dimming level: 4096 levels
- Dimming range: 0.1 - 100%
- Dimming curve: Logarithmic

ROTATING WHEEL REMOTE (F)

- Working Voltage: 3V (CR2032 battery)
- Transmitting power: 6dBm
- Standby power Consumption: <6µA
- RF: 2.4GHz
- Working Temperature: 10~40°C
- Control distance: 30m

